

# DIAMOND SERIES INTRODUCTION

## SWG5E Type

Website:[www.chinasuntree.com](http://www.chinasuntree.com)

Email: [miya@chinasuntree.com](mailto:miya@chinasuntree.com) Cellphone: +86 13957796264

# Product Overview



Specification						
Standard	Type 2 & GB/T			Type 1 (J1772)		
Model	SWG5E-7/32	SWG5E-11/16	SWG5E-22/32	SWG5A-7/32	SWG5A-9/40	SWG5A-11/50
Power	7kw	11kw	22kw	7kw	9kw	11kw
Rated Voltage	230VAC	380VAC		230VAC		
Current	32A	16A	32A	32A	40A	50A



**Box size: 530\*320\*280mm**

**Weight: 10kg**

**Product Display: Color Optional & Delicate Packaging**



**Dark Grey**



**Silver**



**Rose Gold**



# Product Advantages – SWG5E



Type 2

Type 1

GB/T

## ⇨ Easy operation

- **Plug-in and play**: Plug-in the charging cable and start charging directly
- **RFID**: Start / Stop charging by RFID card
- **APP**: Remote control, such as start/stop charging, adjust current, etc.

## ⇨ Network Connection Method

- **4G** (Support OCPP 1.6J connection & APP connection)
- **Ethernet** (Support OCPP 1.6J connection & APP connection)
- **WIFI / Bluetooth** (APP connection)

## ⇨ Customization

- Support **LOGO** customization
- Support **Cable Length** customization
- Support **screen Language** customization

## ⇨ Multiple Option

- **Type 1, Type 2 and GB/T** charging cable.
- Adjustable output current (From the App)
- Wall-mount / Floor-stand installation

## ⇨ Secure Protection

- Over temperature protection, over/under voltage protection, etc.
- Will **automatically** stop when fully charged.

# Product Advantages – SWG5E

⇒The device has detailed **error alerts**

- Our device will have error alerts, the screen will show the fault.

For the **basic error**, you can check the **instruction book**, and find out how to resolve it.

- Or you can contact our **after-sale service**, our sales team and engineer team will stand by your sides.



• **Over current protection**

8. (1) The vehicle current limiter does not limit the charging current, which triggers the over current protection of the ev charger.  
(2) End charging, and the ev charger returns to normal when the power is turned off and reset.



• **Grounding protection**

10. (1) The PE ground wire of the input power cord of the EV charger is suspended or not connected properly.  
(2) Check the ground wire, connect the ground wire and return to normal.

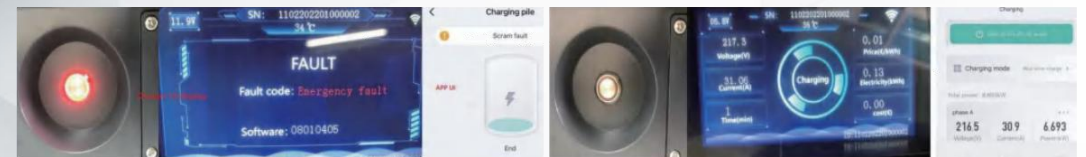

(1)

(2)

9. **Application scenario:**

**Major accidents, such as fire, flood and other natural disasters; to prevent electric shock, fire or explosion.**

(1) The emergency stop button of the EV charger is pressed to stop charging; the emergency stop button turns red, and the charging pile interface displays "Emergency fault" and the mobile APP displays "Scan fault".

(2) Press out the emergency stop button of the EV charger, return to normal, and continue charging.

# Product Certification – SWG5E



## LOW VOLTAGE DIRECTIVE, ELECTROMAGNETIC COMPATIBILITY DIRECTIVE ATTESTATION OF CONFORMITY

Technical file of the company mentioned below has been inspected and audit has been completed successfully.  
2014/30/EU Electromagnetic Compatibility Directive and 2014/ 35/EU Low Voltage Directive has been taken as references for these processes.

Company Name : Suntree Electric Group Co., Ltd.  
Company Address : Xinguang Industrial Zone, Lushi Town, Yueqing City, Zhejiang, 325604, China  
Related Directives and Annex : 2014/35/EU Low Voltage Directive /Annex III  
2014/30/EU Electromagnetic Compatibility Directive /Annex II  
Related Standards : EN IEC 61851-1:2019; EN 62752:2016/A1:2020  
EN IEC 61851-21-2:2021; EN IEC 61000-6-1:2019  
EN IEC 61000-6-3:2021  
Product Name : AC EV Charger  
Report No and Date : DDTE230613232.DDTE230613233  
Product Brand/Model/Type : SWG4E-7/32, SWG5E-7/32, SWG5E-11/16, SWG5E-22/32,  
SWG6E-7/32, SWG6E-11/16, SWG6E-22/32, SWJ3E-7/32,  
SWJ3E-11/16, SWJ3E-22/32

Certificate Number : M.2023.206.C88351  
Initial Assessment Date : 27.07.2023  
Registration Date : 28.07.2023  
Reissue Date/No : -  
Expiry Date : 27.07.2028

  
UDEM International Certification  
Auditing Training Centre Industry  
and Trade Inc. Co.



The validity of the certificate can be checked through [www.udem.com.tr](http://www.udem.com.tr). Upon completion of EC declaration of conformity it is used solely at the manufacturer's responsibility. This certificate remains the property of UDEM International Certification Auditing Training Centre Industry and Trade Inc. Co. to whom it must be returned upon request. The above named firm must keep a copy of this certificate for 15 years from the registration of certificate. This certificate only covers the product(s) stated above and UDEM must be notified in case of any changes on the product(s).  
Address: Mithakemir Mahallesi 2073 Sokak (Eski 93 Sokak) No:10 Çankaya - Ankara - TURKEY  
Phone: +90 0312 443 03 90 Fax: +90 0312 443 03 76  
E-mail: [info@udem.com.tr](mailto:info@udem.com.tr) [www.udem.com.tr](http://www.udem.com.tr)

شهادة – Certificat – 증명서 – 證明書 – Сертификат – Certificate

Form QA110\_M08, version 01, effective since September 5<sup>th</sup>, 2022

## Certificate of Compliance



No. 4Q230831.SEGQW53

Test Report / Technical Construction File no. DDTE230823315

Certificate's Holder: Suntree Electric Group Co., Ltd.  
Xinguang Industrial Zone, Lushi Town, Yueqing City, Zhejiang, 325604, China

Certification ECM Mark:



Product: AC EV Charger  
Model(s): SWG5E-7/32, SWG5E-11/16, SWG5E-22/32

Verification to: Standard: BS EN IEC 61851-1:2019, BS EN 62752:2016/A1:2020  
related to GBR Regulation:  
Electrical Equipment (Safety) Regulations 2016

**Remark:** This document has been issued on a voluntary basis and upon request of the manufacturer. It is our opinion that the technical documentation received from the manufacturer is satisfactory for the requirements of the ECM Certification Mark. The conformity mark above can be affixed on the product(s) accordingly to ECM regulation about its release and its use. The regulation can be found at [www.entecema.it](http://www.entecema.it).

Additional information and clarification about the Marking:



The manufacturer is responsible for the UKCA Marking process, and if necessary, must refer to a Notified Body. This document has been issued on the back of the regulation on ECM Voluntary Mark for the certification of products. K001\_ECM available at: [www.entecema.it](http://www.entecema.it)

Issuance date: 31 August 2023

Expiry date: 30 August 2028



For online check:

Approver  
Ente Certificazione Macchine  
Legal Representative  
Lucia Rosonni



Ente Certificazione Macchine Srl

Via Ca' Bella, 243 – Loc. Castello di Serravalle – 40053 Valsamoggia (BO) - ITALY  
☎ +39 051 6705141 ☎ +39 051 6705156 ✉ [info@entecema.it](mailto:info@entecema.it) 🌐 [www.entecema.it](http://www.entecema.it)

For the  
certification, our  
Charger got **CE**  
and **UKCA**  
certificate



# APP Control – CHARGING GUN STATUS

(PLS NOTED: IN HOME PAGE, IT WILL SHOW THE CHARGING GUN STATUS)

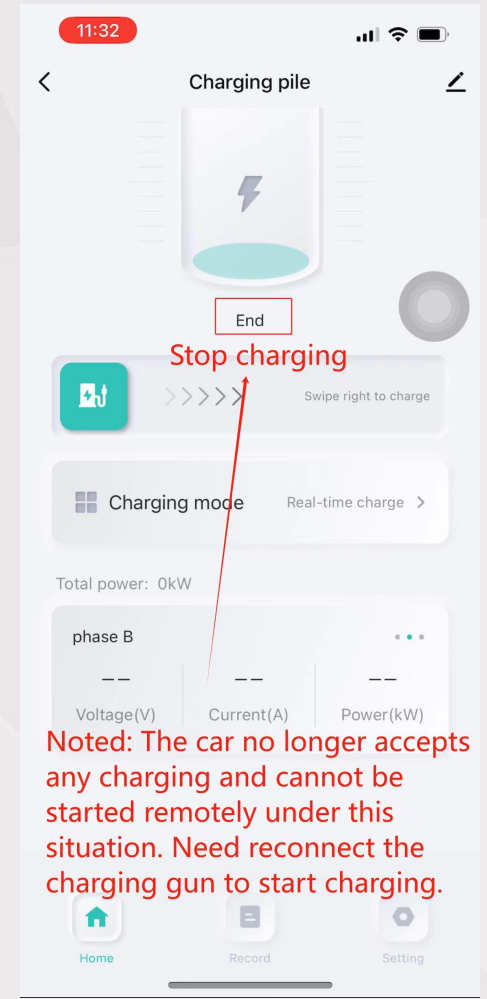
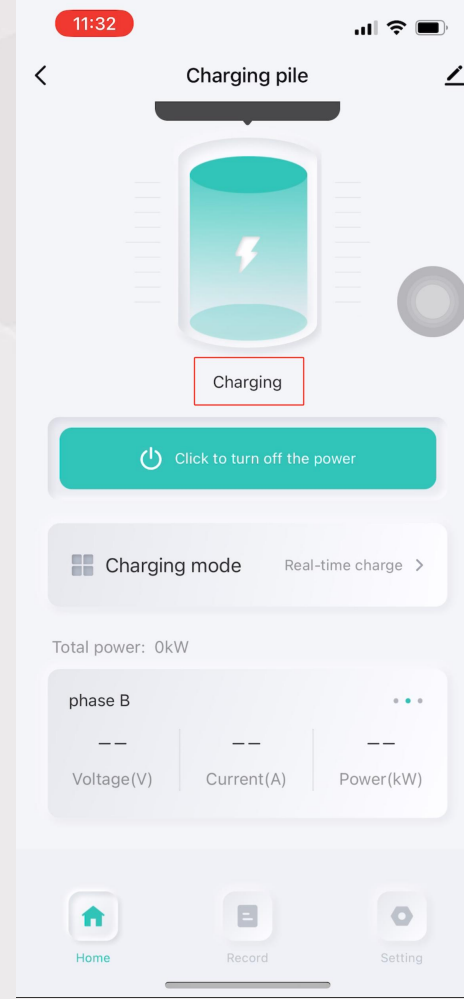
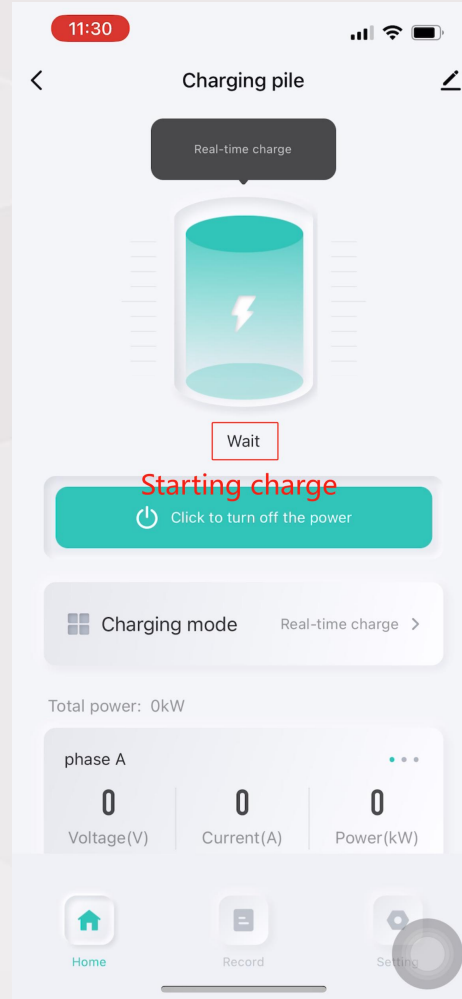
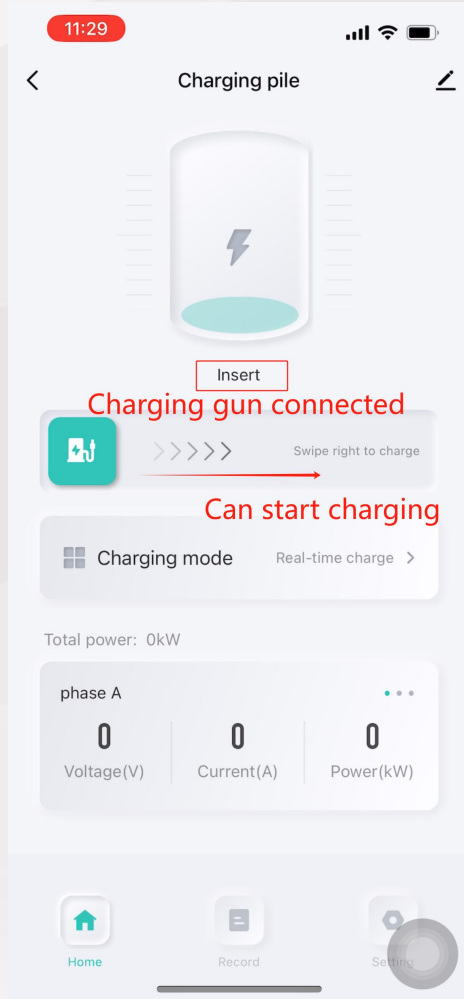
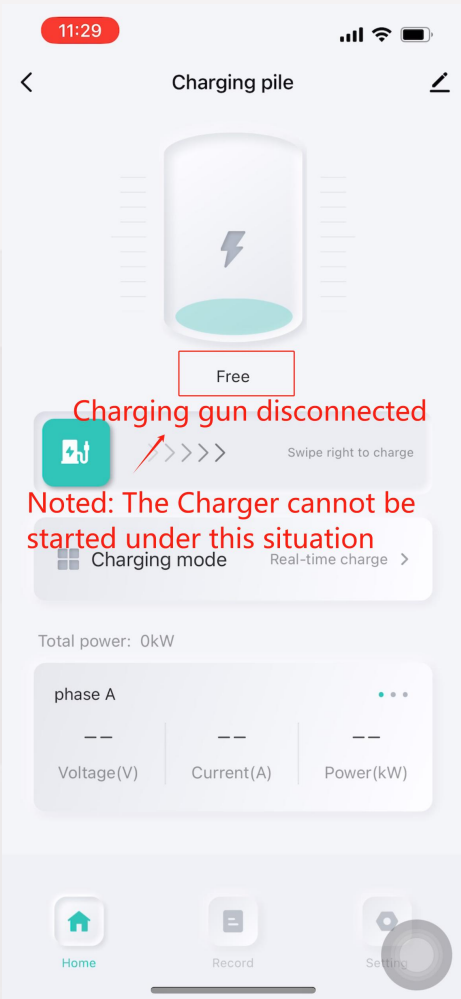

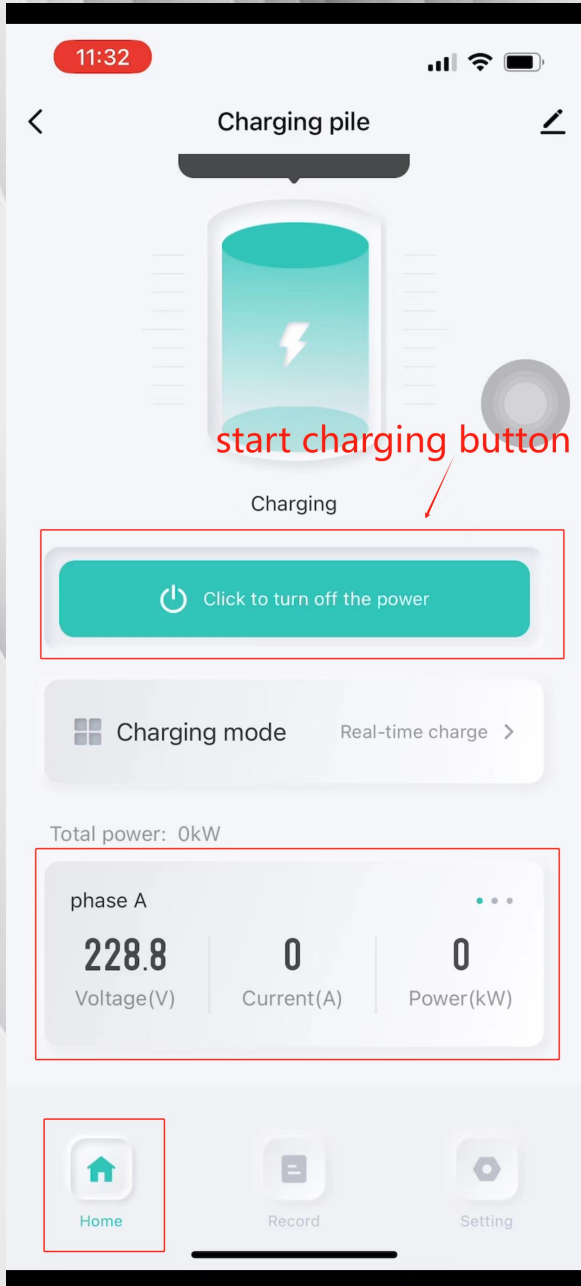

# APP Control – HOME PAGE

## HOME PAGE OPERATION

– on HOME PAGE: **start/stop charging, check the charging status**

– Can do the **RealTime charging** from HOME PAGE  
(↑ ref. the right side picture)

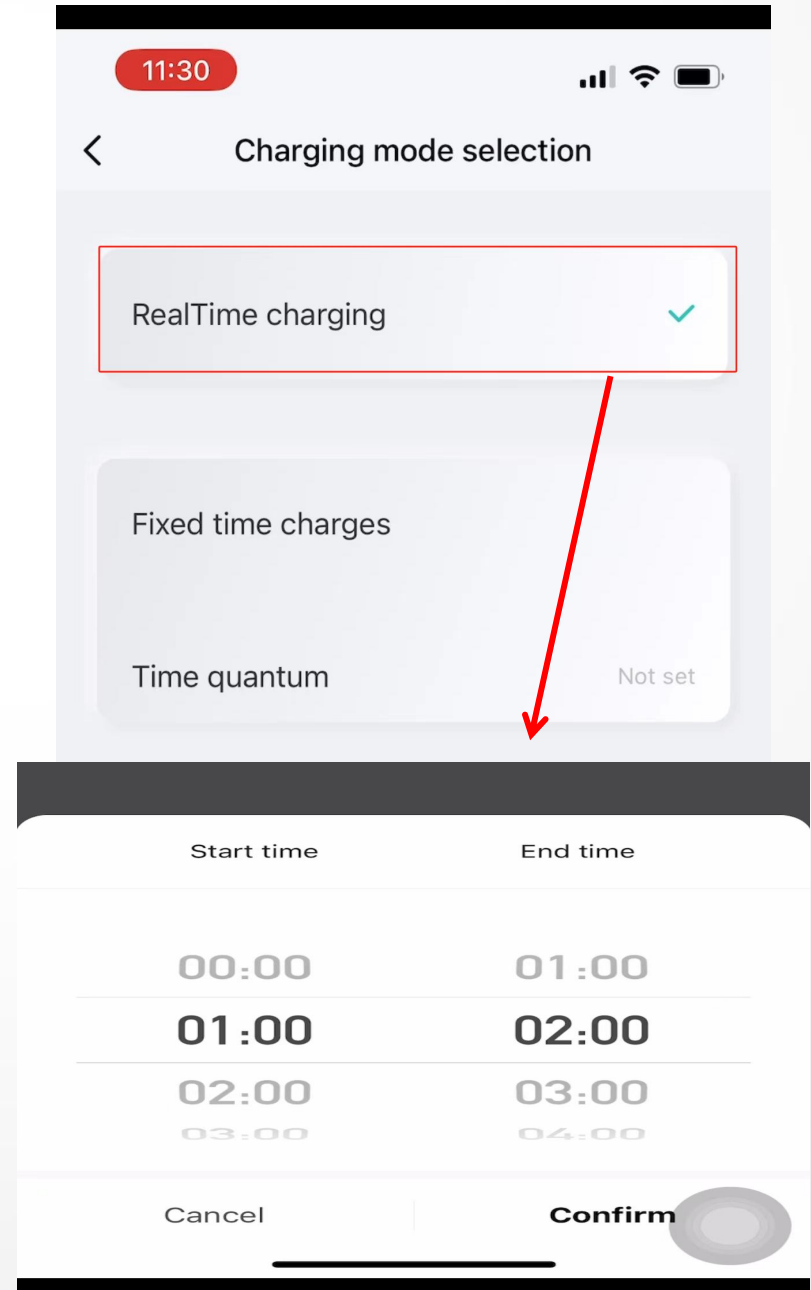



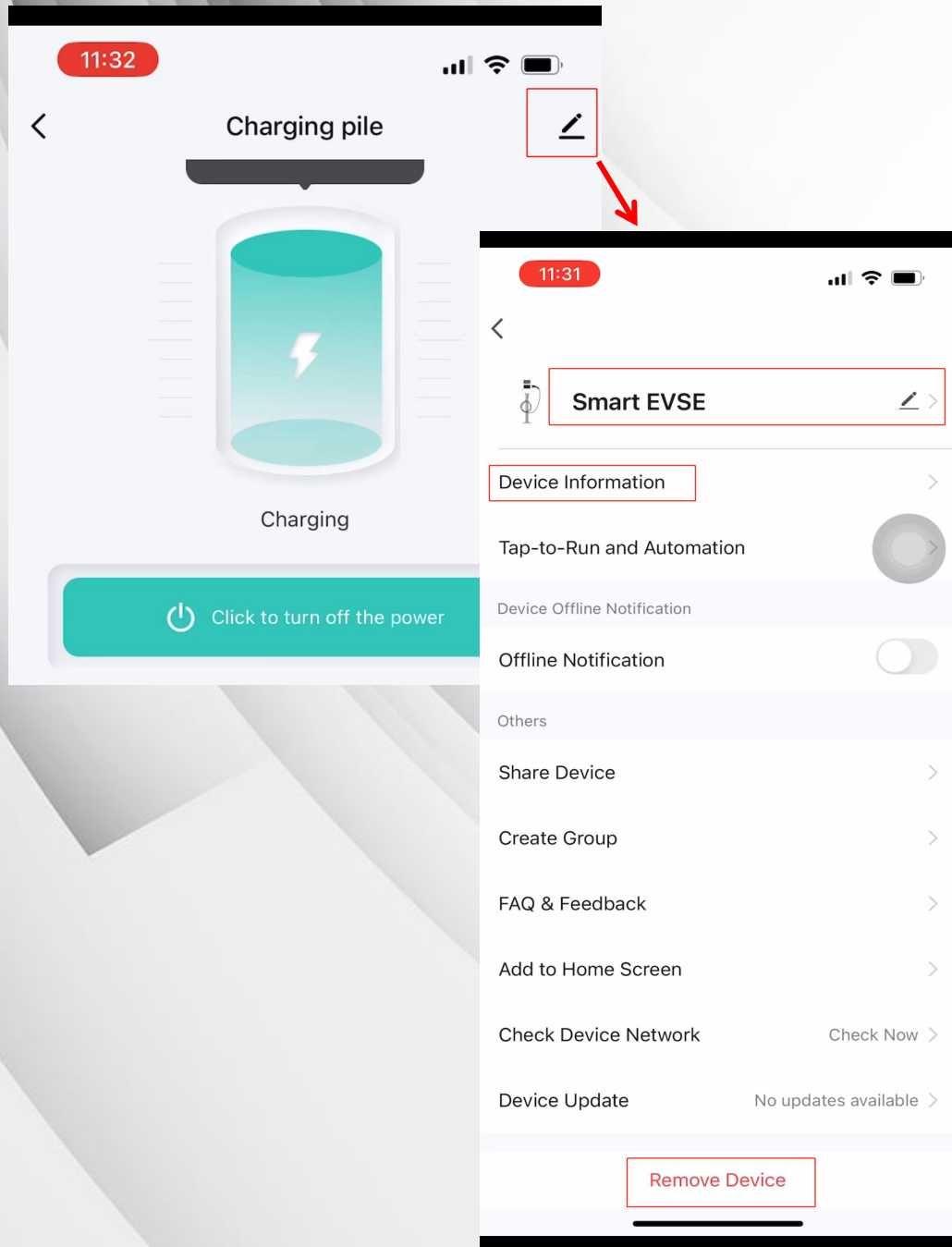

## APP Control – EDIT PAGE

### ⇒EDIT PAGE OPERATION

- can change the **DEVICE NAME**
- can check the **DEVICE INFORMATION**
- can **REMOVE THE DEVICE**
- can **SHARE THE DEVICE** to family member

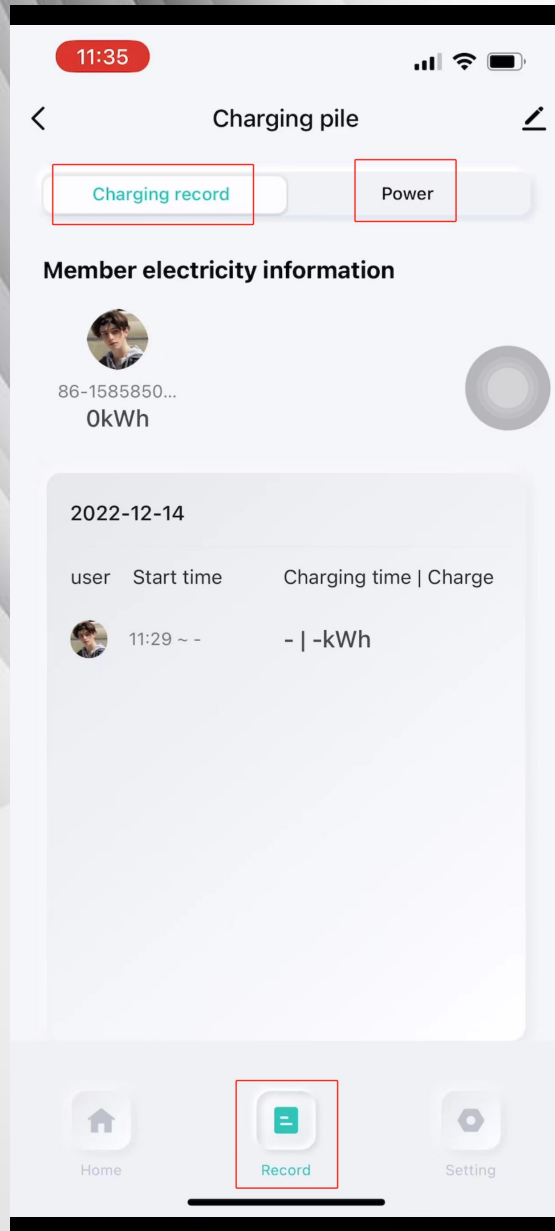

## APP Control – RECORD PAGE

### ⇒RECORD PAGE OPERATION

- can check the **charging record**, like **when start charging**, and the **duration of each charging**
- can check the power of charging use



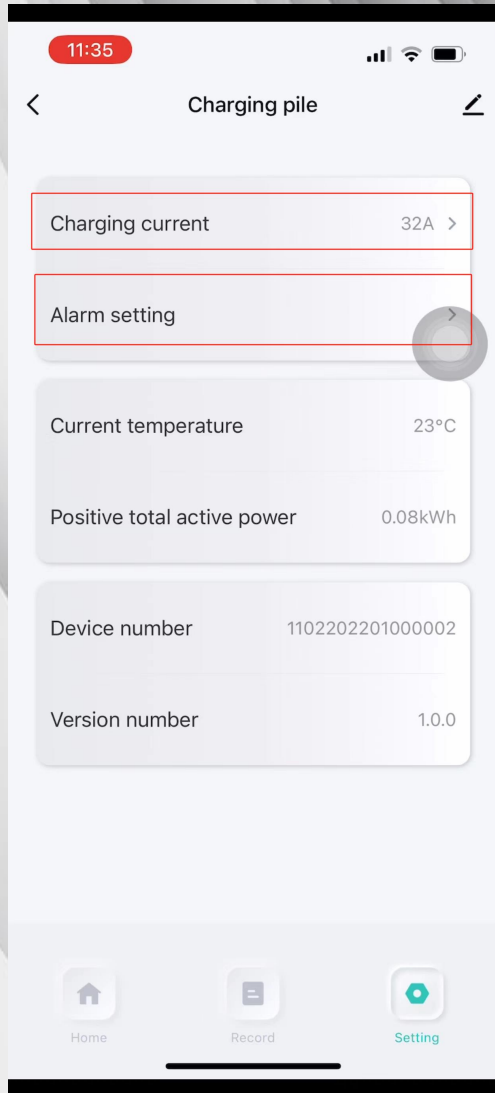

## APP Control – SETTING PAGE

### ⇒SETTING PAGE OPERATION

- Adjust charging current, the Maximum charging current of 7kw and 22kw is 32A, the current can be adjust from 0–32A; for 11kw, Maximum charging current is 16A, it can be adjust from 0–16A.
- Alarm setting (pls ref. the right side picture→)

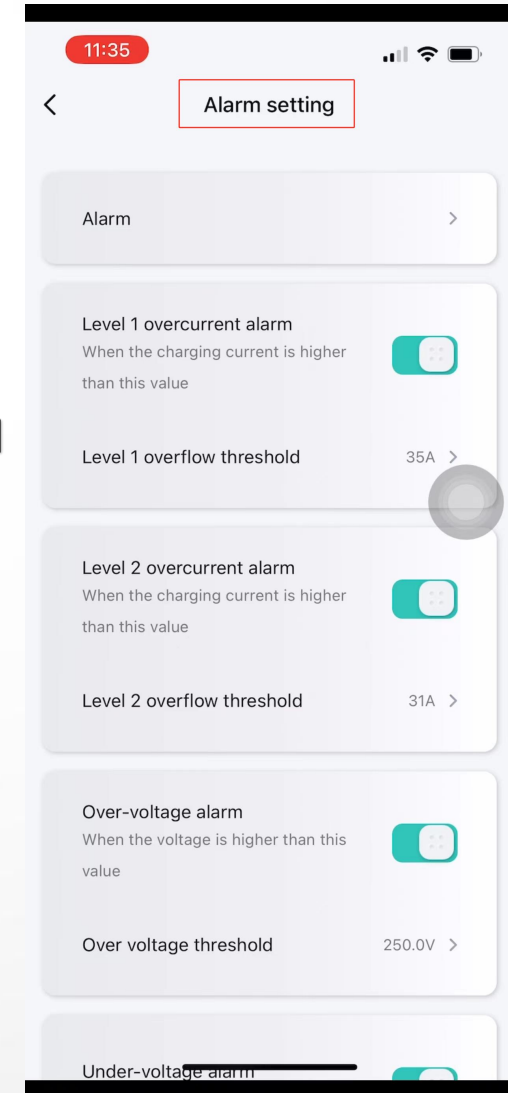

# BUYERS SHOW



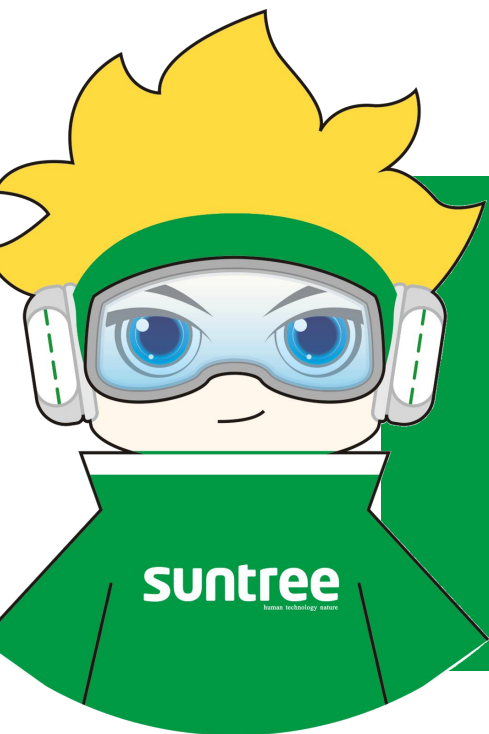

**SUNTREE**  
**KEEP YOUR BELOVED ONE**  
**PROTECTED FROM ELECTRICITY**

Website:[www.chinasuntree.com](http://www.chinasuntree.com)

Email: [miya@chinasuntree.com](mailto:miya@chinasuntree.com) Cellphone: +86 13957796264